

**OBSOLETE**

# MEP-7011, 7013, 7711, 7713 Direct Coupled Tri-State ControlSet Actuators 150/300 Inch-Pound

## Description

The KMC MEP-7011/7013/7711/7713 ControlSet Actuators are designed to regulate large control air dampers and valves in HVAC systems. The 7011 and 7711 have tri-state control signal inputs, and the 7013 and 7713 have Tri-state control signal inputs with an added feedback potentiometer output.

These actuators mount directly to 3/8" up to 1.05" round or 5/16" up to 5/8" square shafts, eliminating the need for expensive and complicated linkage. These bidirectional actuators may be controlled via a SPDT floating thermostat, controller, or building automation system. A minimum 150 in-lb of torque is available on the 7000 series and a minimum 300 in-lb of torque is available on the 7700 series over the 94° angular rotation.

A gear disengagement feature allows positioning of the damper and/or gear train without energizing the actuator. The actuators are protected against overloading and do not require end or limit switches.

## Features

- ◆ Direct mounting to standard shaft sizes
- ◆ Bidirectional motors may be controlled by SPDT floating thermostat or building automation system
- ◆ Gear disengagement feature
- ◆ 150 and 300 inch-pound models
- ◆ Built-in overload protection
- ◆ Optionally wire for 2-position operation

## Application

The MEP-7011/7013/7711/7713 ControlSet Actuators are intended to control large control air dampers and valves in HVAC systems.



## Models

The following models are available:

MEP-7011	150 in-lb Tri-state
MEP-7013	150 in-lb Tri-state with feedback
MEP-7711	300 in-lb Tri-state
MEP-7713	300 in-lb Tri-state with feedback

## Accessories

The following accessories are available:

CME-7001	Single Auxiliary Switch
CME-7002	Dual Auxiliary Switch
HMO-4535	Non-rotational bracket
HMO-4536	Stop Kit
HLO-1020	Crankarm Kit
HCO-1152	Weather Shield Kit

## Details

All dimensions are in inches (mm).

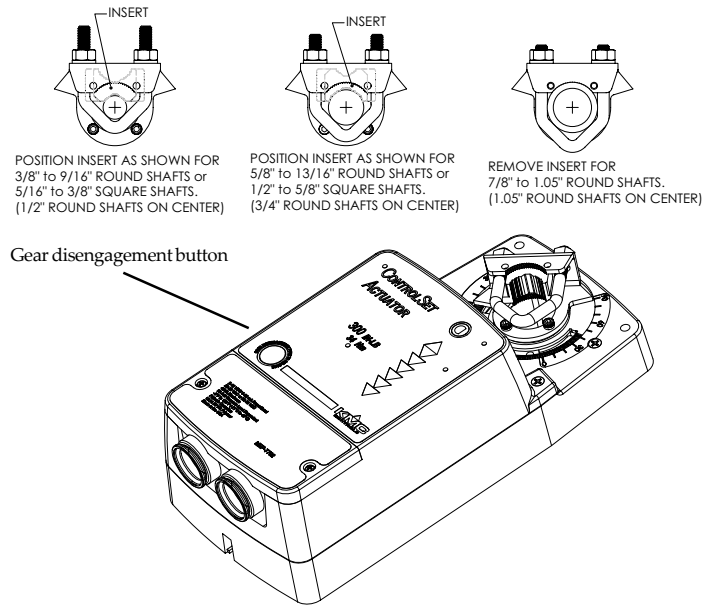
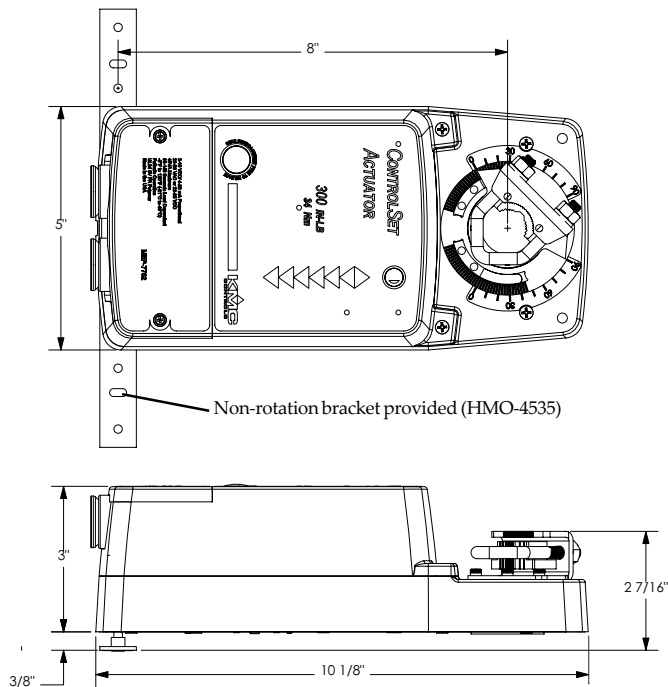

DAMPER TYPE	Up to 1000 FPM	1000 to 2500 FPM	2500 to 3000 FPM
Opposed Blade without seals	3 in.-lb. / sq.-ft	4.5 in.-lb. / sq.-ft	6 in.-lb. / sq.-ft
Parallel Blade without seals	4 in.-lb. / sq.-ft	6.0 in.-lb. / sq.-ft	8 in.-lb. / sq.-ft
Opposed Blade with seals	5 in.-lb. / sq.-ft	7.5 in.-lb. / sq.-ft	10 in.-lb. / sq.-ft
Parallel Blade with seals	7 in.-lb. / sq.-ft	10.5 in.-lb. / sq.-ft	14 in.-lb. / sq.-ft

## Specifications

**Supply Voltage** 24 VAC, +20%/-15% or 22 to 35 VDC

**Supply Power** MEP-7011/7013 6 VA  
MEP-7711/7713 8 VA

**Control Input** Floating  
24 VAC +20%/-15% or 22 to 35 VDC

**Feedback** 10K ohm, 1/3 watt.  
(7013/7713 only)

**Torque**  
MEP-7011/7013 150 in.-lb. (17 N•m)  
MEP-7711/7713 300 in.-lb. (34 N•m)

**Angular Rotation** 94°; fully adjustable with HMO-4536 Stop Kit

**Motor Timing** 90 to 140 seconds, load dependent

**Mounting** Direct to 3/8" to 1.05" round or 5/16" to 5/8" square shaft secured by adjustable "V" bolt and non-rotational bracket HMO-4535 (supplied). Minimum recommended damper shaft length is 2.5".

### Connections

Wire clamp type; 14–22 AWG, Copper

### Weight

5 lb. (2.27 kg)

### Material

Black flame retardant polymer, UL94-5V plenum rated

### Noise Level

45 dbA, maximum

### Approvals

UL Listed

### Temperature Limits

Operating -5° to 120°F (-21° to 49°C)  
Shipping -40° to 140°F (-40° to 60°C)

### KMC Controls, Inc.

19476 Industrial Drive

New Paris, IN 46553

574.831.5250

www.kmccontrols.com