

Description

The KMC VEP-558 Series Butterfly control valves are 2-way straight through for high capacity control in low-pressure hot water, chilled water, or steam applications. The metal-seated butterfly valve requires less actuator operating torque and should only be used where 1-3 percent leakage, in the closed position, is acceptable.

These valves are set for a full quarter-turn (90° rotation) for optimum flow characteristics. The valves come assembled in the normally closed position. The unique universal system of brackets and linkage allow for easy field changes of the action to normally open.



Features

- ◆ Control actuators
- ◆ Self-adjusting packing
- ◆ Stainless steel stems
- ◆ Unique brackets and linkage that allow easy field changes

Accessories

The following accessories and repair parts are available:

CME-7001	Single end switch
CME-7002	Dual end switch

Consult with factory when service conditions are higher than 50 psi and when optional valve materials or construction are required.

Specifications

Valve Size	2"-12"
Body Type	ANSI 125 & 150 wafer style flange mating. All have 4 alignment holes.
Flow Characteristics	Linear
Maximum Differential Pressure	50 psi for water (35 psi for steam)

Cv Rating @ 90%	2"=90; 2-1/2"=194; 3"= 370; 4"=747; 5"=1272; 6"= 1999; 8"=3853; 10"=6361; 12"= 9164
------------------------	---

Pressure Drop (PSI) @ 90° Rotation	2"=1.4; 2-1/2"=0.6; 3"=0.4; 4"=0.3; 5"-12"=0.2
---	---

Material

Body	Cast Iron
Disc	Cast Iron
Seat	Swing through
Shaft	416 Stainless Steel
Bushing	Graphite Bronze
Packing	Graphite Teflon
Packing Nut	Brass

Temperature Limits

Media	25° to 280° F (-4° to 138° C)
Ambient	0° to 120° F (-18° to 49° C)
Shipping	-40° to 140° F (-40° to 60° C)

Freeze protection required for fluid temperatures below 32°F (0° C).

VEP-558XYZZZ

X		Y		ZZZ	
Size	Value for "X"	Actuator Qty. & Size	Value for "Y"	Actuator (Choose one)	Value for "ZZZ"
2"	1	One (1) 100 in-lb or 150 in-lb actuator	1	100 in-lb MEP-1262, 2 to 10 VDC	845
				100 in-lb MEP-1263, Tri-State w/FB*	856
2-1/2"	2			100 in-lb MEP-1272, 2 to 10 VDC, fail-safe	875
				100 in-lb MEP-1273, Tri-state, fail-safe,w/ FB*	886
				150 in-lb MEP 7002, 2 to 10 VDC	645
3"	3			150 in-lb. MEP-7003, Tri-state	656
				150in-lb MEP-7052, 2 to 10 VDC, fail-safe	675
				150 in-lb MEP-7053, Tri-state, fail-safe, w/FB*	686
4"	4			One (1) 150 in-lb actuator	1
		150 in-lb. MEP-7003, Tri-state, w/FB*	656		
		150in-lb MEP-7052, 2 to 10 VDC, fail-safe	675		
		150 in-lb MEP-7053, Tri-stet, fail-safe, w/FB*	686		
5"	5	One (1) 300 in-lb actuator	1	300 In-lb MEP-7702, 2 to 10 VDC	945
6"	6			300 in-lb MEP-7703, Tri-state, w/FB*	956
8"	7			300 in-lb MEP-7752, 2 to 10 VDC, fail-safe	975
				300 in-lb MEP-7753 Tri-State, fail-safe, w/FB*	986
10"	8	Two (2) 300 in-lb actuator	2	300 In-lb MEP-7702, 2 to 10 VDC	945
12"	9			300 in-lb MEP-7703, Tri-state, w/FB*	956
				300 in-lb MEP-7752, 2 to 10 VDC, fail-safe	975
				300 in-lb MEP-7753, Tri-state, fail-saf, w/FB*	986

* w/FB = with Feedback

Using the table (above) determine the "X", "Y" and "ZZZ" values that correspond to your application.

Examples of valid model numbers:

VEP-55811886: A 2" valve with one MEP- 1273 actuator.

VEP-55892945: A 12" valve with two MEP-7702 actuators.

Examples of invalid model numbers:

VEP-55872645: A request for an 8" valve with two MEP-7002 (150 in-lb) actuators. The correct part number would be VEP-55871945. An 8" valve with one 300 in-lb MEP-7702 actuator.

VEP-55891975: A request for a 12" valve with only one actuator. All 12" valves must have two actuators. The correct model number should be VEP-55892975.

Details

Dimensions in inches (mm) and weight in pounds (kg)

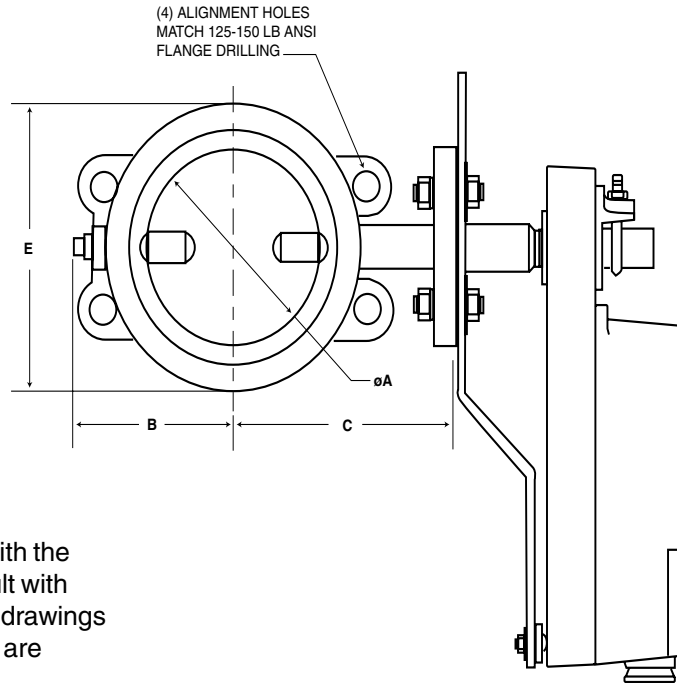

NOTE: Valve dimensional drawings are shown with the MEP-7000 series ControlSet™ Actuators. Consult with KMC Controls' Technical Service for dimensional drawings if MEP-1200 or dual MEP-7000 Series Actuators are required.

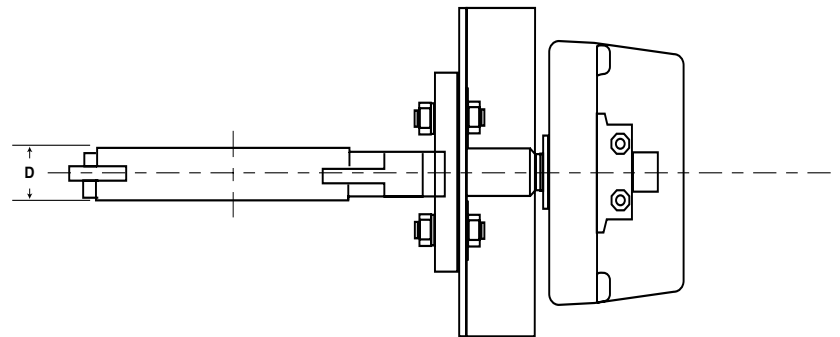

Models	A	B	C	D	E	Weight
VEP-55811ZZZ	2" (50.8)	2-3/4" (69.85)	5-3/8" (135.53)	1-1/2" (38.1)	3-7/8" (98.43)	19 lbs. (8.62)
VEP-55821ZZZ	2-1/2" (63.5)	3" (76.2)	5-5/8" (142.88)	1-1/2" (38.1)	4-5/8" (117.48)	20 lbs. (9.07)
VEP-55831ZZZ	3" (76.2)	3-1/8" (79.38)	5-7/8" (149.23)	1-1/2" (38.1)	5-1/4" (133.35)	21 lbs. (9.52)
VEP-55841ZZZ	4" (101.6)	4-1/4" (107.96)	6-3/8" (161.93)	1-1/2" (38.1)	6-3/8" (161.93)	22 lbs. (9.97)
VEP-55851ZZZ	5" (127)	4-7/8" (123.83)	6-7/8" (174.63)	1-1/2" (38.1)	7-1/2" (190.5)	31 lbs. (14.06)
VEP-55861ZZZ	6" (152.4)	5-3/8" (136.53)	7-3/8" (187.33)	1-1/2" (38.1)	8-1/2" (215.9)	33 lbs. (14.97)
VEP-55871ZZZ	8" (203.2)	6-1/2" (165.1)	9-5/8" (244.48)	1-1/2" (38.1)	10-3/4" (273.05)	48 lbs. (21.77)
VEP-55882ZZZ	10" (254)	8" (203.2)	10-5/8" (269.88)	1-7/8" (47.63)	13" (330.2)	56 lbs. (25.40)
VEP-55892ZZZ	12" (304.8)	9-1/2" (241.3)	11-5/8" (295.28)	1-7/8" (47.63)	15-1/4" (387.35)	66 lbs. (29.94)

KMC Controls, Inc.
19476 Industrial Drive
New Paris, IN 46553
574.831.5250
www.kmcccontrols.com